

**DEP301: COLLABORATIVE DESIGN PROJECT**

# **WFH Workspace**

Week 2 : Analysis and Product Requirements

## **Team GG**

Prita Raut 18U130024

Pratyush Negi 18U130023

C Tarun Karthick 18U130011

# SO FAR

In the last week we brainstormed, narrowed down to a problem, did research, got some insights and redefined our problem statement

- Initial Brainstorming and Shortlisting
- Secondary Research and Final Problem Selection
- Problem Statement
- Primary Research and Market Study
- Key Insights from Research
- Redefined Problem Statement
- Existing Solutions

# CONTENTS

<b>So Far</b>	<b>2</b>
<b>Key Insights</b>	<b>3</b>
<b>Redefined Problem Statement</b>	<b>4</b>
<b>What kind of privacy?</b>	<b>7</b>
<b>Problems in the existing products</b>	<b>9</b>
<b>Scenarios and Needs</b>	<b>10</b>
Scenario 1	14
Scenario 2	15
Scenario 3	16
<b>Product Requirements</b>	<b>20</b>

# KEY INSIGHTS FROM RESEARCH

The key insight that we got from the study is that people need a private space. Our users had their family members interfering with their workspace unintentionally disturbing them causing them to lose focus. People primarily need a private space where they don't want to be intruded. Family members unintentionally interrupt user's work flow.

One of the users doesn't have any problem as such with his current set up. but his brother who shares the bedroom with him has to adjust because user wants his personal space. We also saw people prioritising privacy over comfortable furniture.

People do not want to make structural changes in their current existing home to get a better workspace because they have somewhat adapted to their situation and spending so much money on changing the interior is not worth it. Solution should be something affordable.

Why we were trying to see if people are willing to make structural changes is because there are two approaches that we could have taken. One was to design for houses that are yet to be constructed and the other one is to design for spaces that have already been constructed and people are living there. We want to design for houses that are already there. Structural changes are not something you do a lot. So it was necessary to understand to what extent the users are willing to make changes in their house and spend to have a better experience of working from home.

There are furniture related issues for example more people are working from home but the family has only one desk, those issues are solvable by existing furniture designs. There are a lot of options available in the market to meet the needs of comfort, space, aesthetics, etc which would involve some rearrangement of things in the room. There are no special needs for that. The reason people currently don't have them is because they didn't find the dire need for them currently.

So the main concern is private and personal space which is required to stop distractions caused by family members unintentionally intruding. Invisible boundaries can often be misunderstood and can cause trouble.

# REDEFINED PROBLEM STATEMENT

Designing for privacy in a home workspace to reduce distractions created by home environment for a person working in a shared space at home without making structural changes.

# WHAT KIND OF PRIVACY

We went back to our users and talked about what kind of privacy do they want when they are working and why did they want that.

## **Diversion of attention caused by constant movement of people**

People going about their life, moving around the user's workspace would cause the user's attention to get diverted again and again everytime someone passes by. In this way family members unintentionally disturbed the user.

## **Family members unsure of whether it is okay to talk or not**

User asked his mother to not disturb him an hour back. Now after an hour mother has to ask something to the user and is unsure if the user is still not to be disturbed or it is okay to talk to him now. People can sit in the same place where they work, where they have set up their desktop for some other work which requires them to use it. For example, to buy groceries, do online shopping, pay bills, etc.

## **Display of home environment in the background during meetings**

People don't want to be worried about what is happening behind their back in the background during meeting calls

## **Inability to concentrate because of people watching**

Some people find it difficult to concentrate on work in front of their family members or when people are watching them.

## **Sounds from household activities**

There is noise from the kitchen, dogs barking and all sorts of other noises that can disturb the user. Some people are using noise cancelling headphones or even normal earphones cut out noise significantly.

# PROBLEMS IN EXISTING PRODUCTS

In terms of privacy even though the existing products can work, they are not usable given the various conditions of houses in India. The problem of privacy arises in houses that are small, that can't dedicate a spot just for building a workspace. In such cases, the existing bulky solutions are unusable.

Most of the products for indoor privacy are meant to be placed on the ground/floor but when in a bedroom setting there is a bed in the middle of the room, division using these products is not possible. There should be option of mounting it on the wall.

Storage is also an issue. When not in use, these take up a lot of volume and can make a small house look cluttered. They are also very expensive.

Curtain partitions are good but need a fixed place only. This might actually be interfering with the look of the overall room. Adding a curtain rod at some places maybe in the middle of the living room may make it look out of place.

# SCENARIOS

We brainstormed various scenarios based on different rooms that people could use, various arrangements, number of people, situations, etc. and we saw what could be done in those scenarios. From this we derived our product requirements.





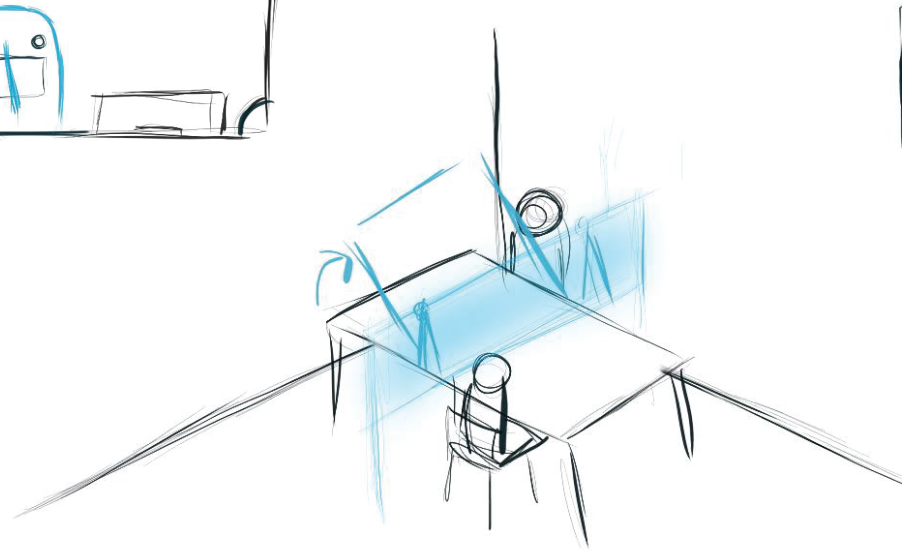
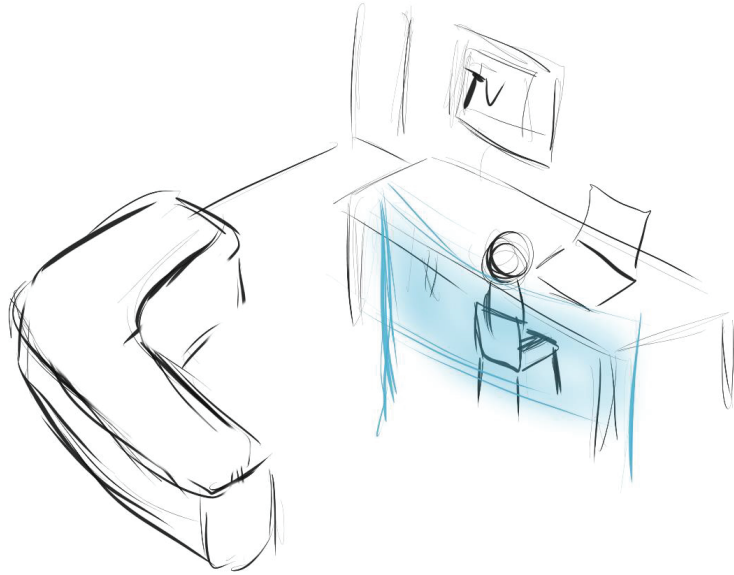
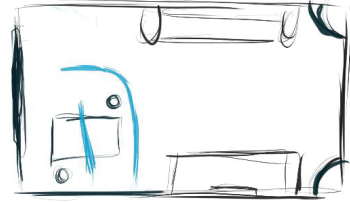
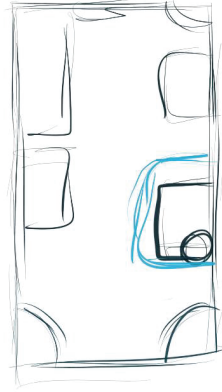
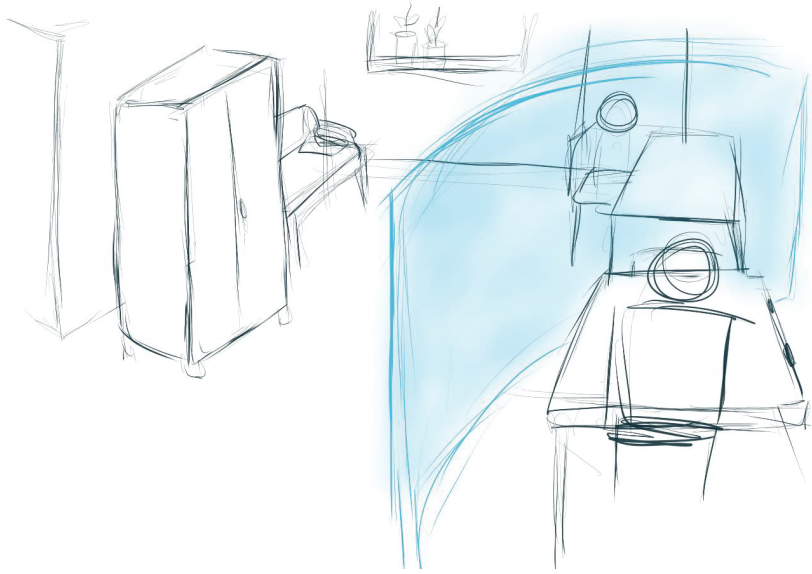

# SCENARIO 1

Two brothers share a bedroom. One of them has workspace in one corner. He wants his personal space to concentrate on work and if people are around him or watching him, he finds it difficult to concentrate so he asks his brother to not be in the room when he is working.

Whatever available products are there can't be used because they are mostly placed on the floor and there is a bed in the middle of the room here and so it won't work. Curtain rod will also disturb the look of the room. maybe we could make something that can be mounted on the wall

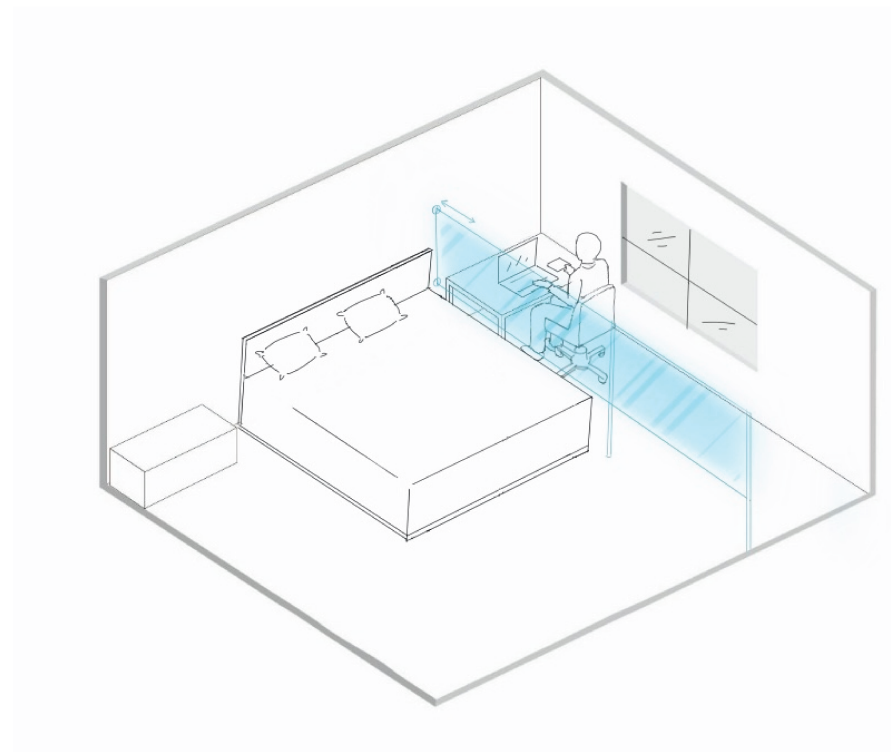
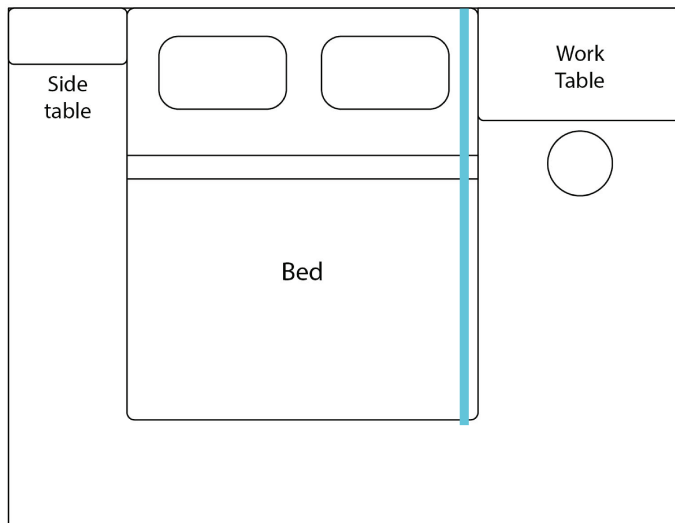

# SCENARIO 2

A person works from his living room and has a wall mounted foldable desk as his workspace. When he is not working it is used for other purposes like for eating food or for cutting vegetables, and so on.

Family members unintentionally interfere now and then, come near his desk while he is working which he doesn't like but they are only trying to go about their life.

There is also sound from the kitchen which is adjacent to the living room for which the person uses noise cancelling headphones.

In this case the person is kind of in the middle of the room and might need a complete enclosure from all sides. But then we should make sure he doesn't feel suffocated and congested. If possible some noise can be blocked out

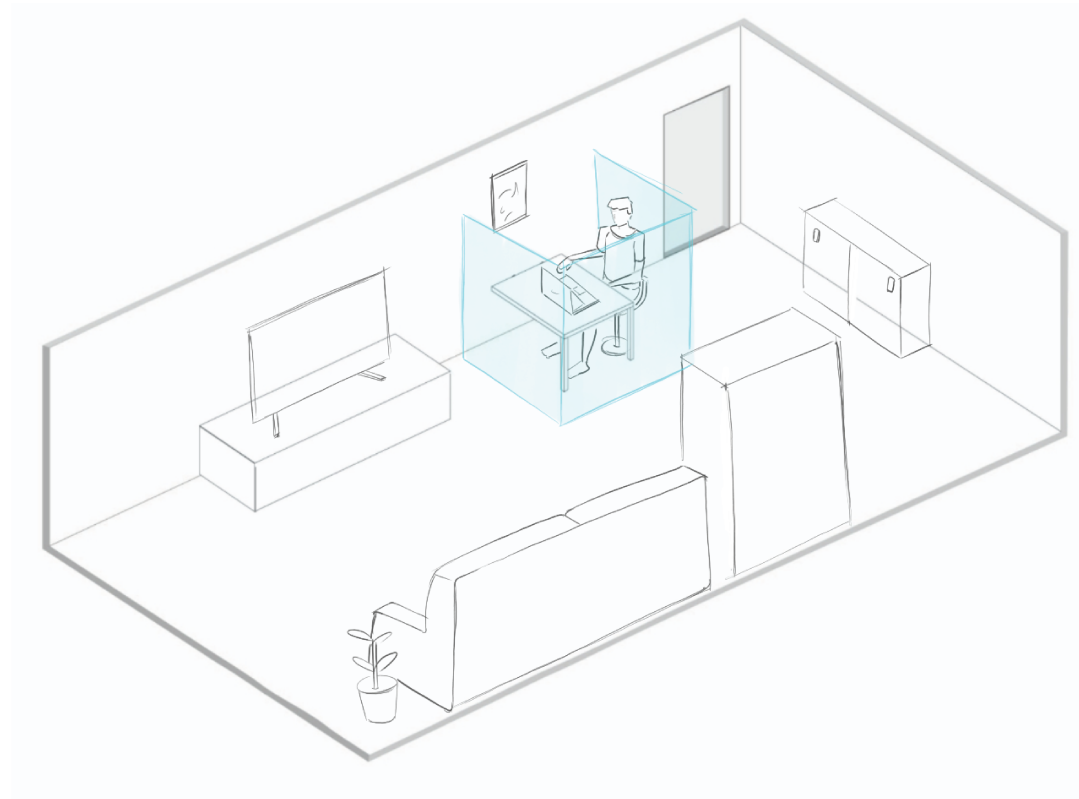
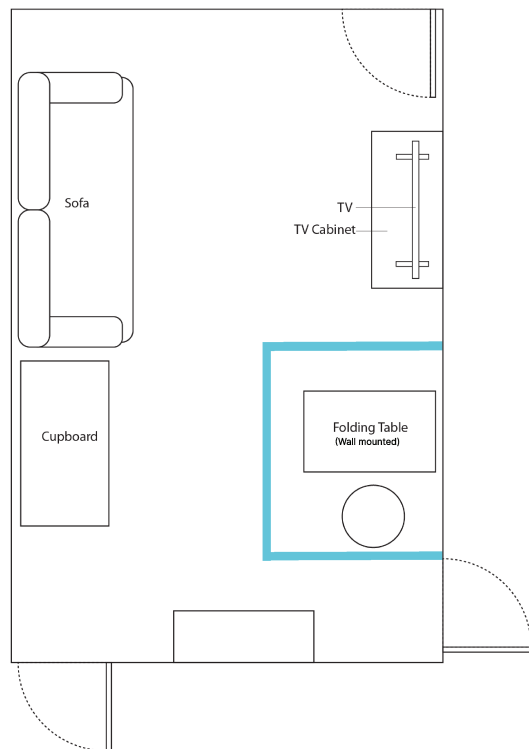

# SCENARIO 3

This is a family of 3, a lady who is a teacher, her retired husband and son who is working from home. The lady takes classes for around 2 hours each day and she uses the desk in the living room as her son works in the bedroom. They have only one table in the living room which is not movable.

The lady is very conscious. She wants to make sure her background is clear. So she informs her husband to make sure he is not seen in the background. The same is the case in the bedroom where his son is working.

The husband has to adjust a lot and has to sit in the same spot of the house on the chair

In this scenario either the lady or the son can use a partition depending on where the husband wants to be. It can be used in either of the rooms. So the product should be such that you can detach it and use it in some other place.

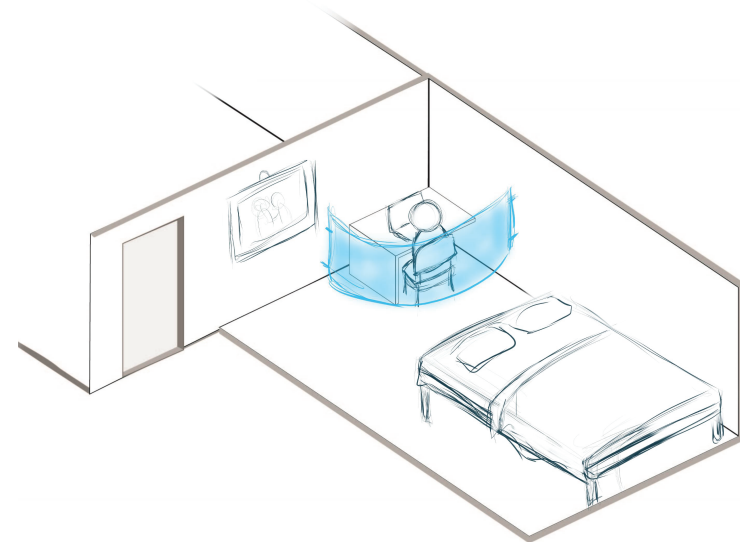
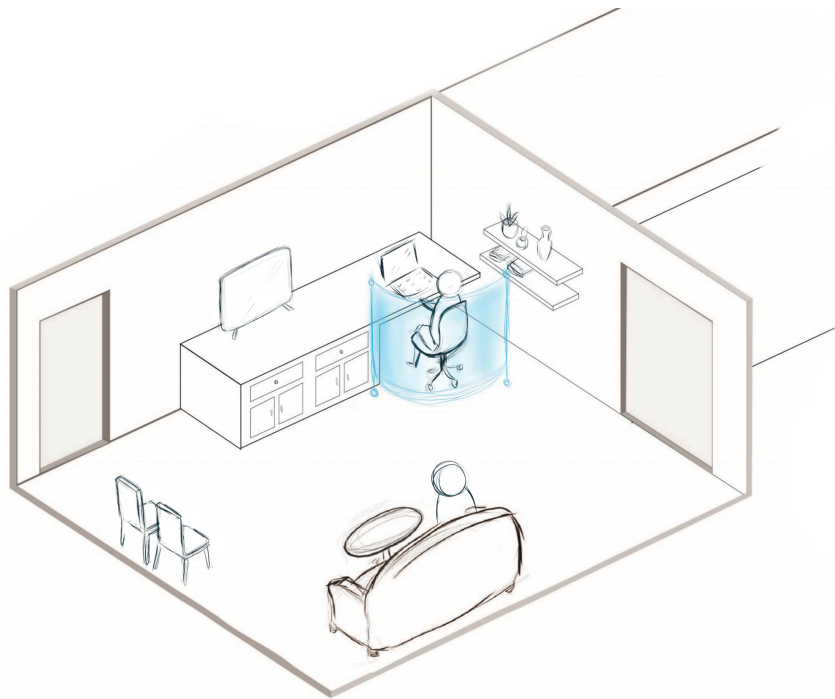

# PRODUCT REQUIREMENTS

## Detachable

The product should be detachable and user should be able to place it anywhere he wants. The product should be complete on its own

## Quick Assembly

There should be minimum prep time. Should be quick to assemble, not more than 2 minutes. It is something that would be used regularly and using the partition may not be a critical task, so if it is taking lot of efforts to assemble before use, the user might be discouraged from using it

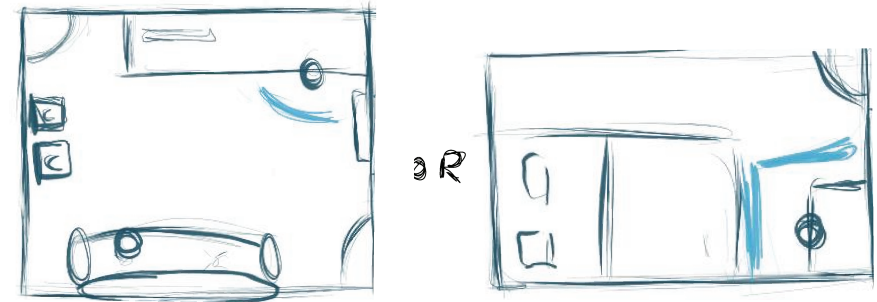

---

## Compact

It should be lightweight, and compact. If it is bulky and big, instead of decreasing problem, it might increase problem by making the house cluttered.

## Storage

It should also be easy and convenient to store when not used. It shouldn't take up a lot of volume and space.

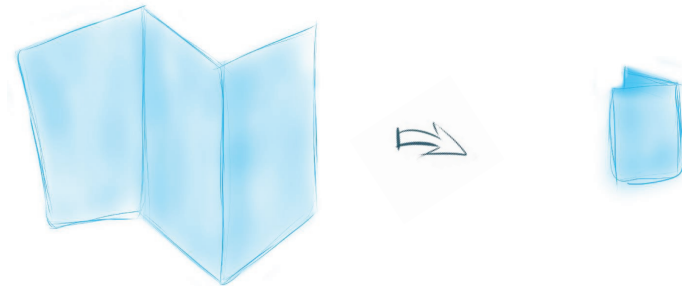

# PRODUCT REQUIREMENTS

## Multiway attach

Sometimes it is not possible to mount on wall, sometimes it is not possible to place on floor and sometimes one side can be mounted on wall and other can be placed on the floor. Or it can be a combination of both. So, there should be provision to do that

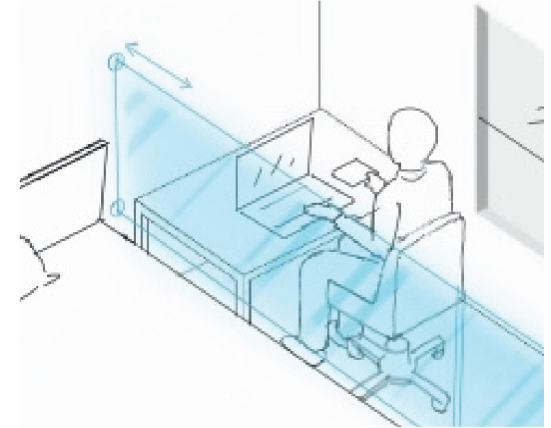
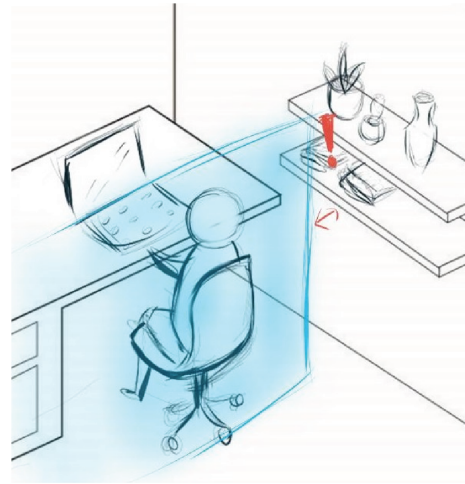

## Length

Rooms are of different sizes. Person might want to enclose partially or completely. In this case the length needs to be variable to fit the length of any room in order to completely close from wall to opposite wall

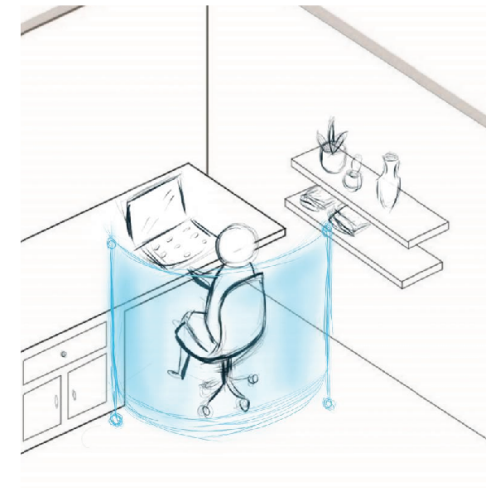
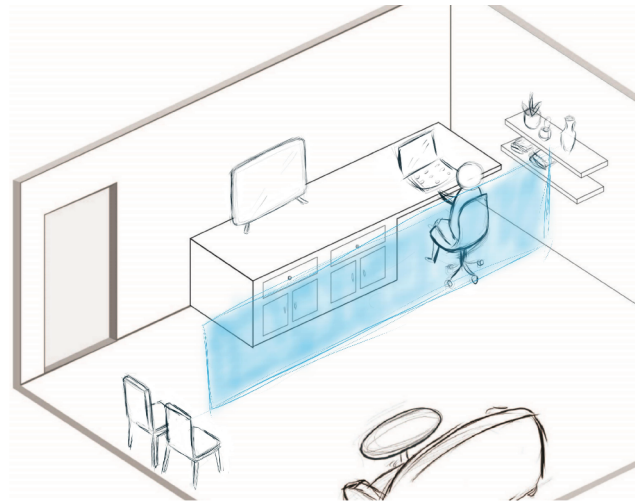

# PRODUCT REQUIREMENTS

## Ventilation

In case of full enclosure, there should be proper ventilation and person shouldn't feel suffocated and congested

## Foldable

The product should be foldable. It should fold or bend at various lengths to accomate various surroundings, shape and structure of workspace, etc

## Aesthetics

It should blend in well with the surroundings. It shouldn't look odd.

## Sound

The product should block some amount of noise if possible

## Cost

The product shouldn't cost more than INR 3000. If it is too expensive, people might just opt for jugaad. If it expensive, it should have that much value

